

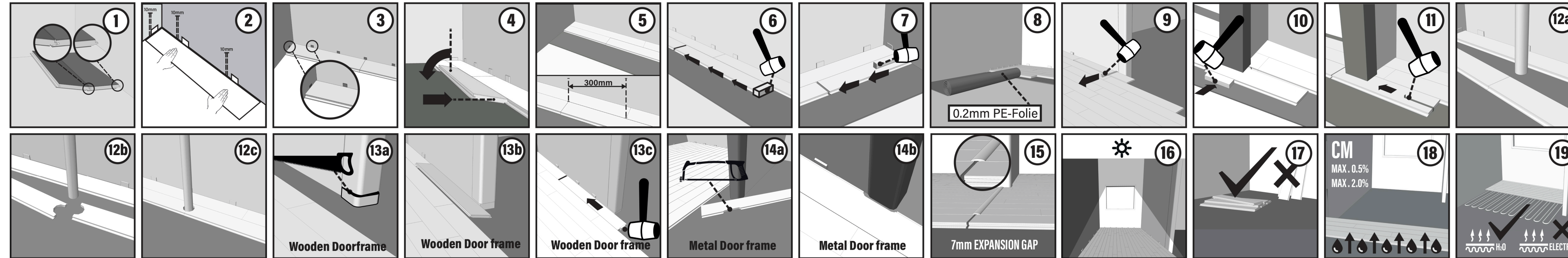

# Clic-Installation instructions



## General

The Republic-Clic system is a revolutionary system for installing vinyl/SPC floors without using adhesive. Thanks to the ingenious form of tongue and groove, the panels can be easily clicked together. Republic-Clic is unique because you can lay the planks in two different ways:

**Method A:** Position the panel to be laid at an angle of 20 to 30° to the panel already laid. Gently move the plate up and down while pushing forward. The panels clic into place automatically. You can either put the tongue in the groove or the groove on the tongue. The tongue in the groove is the simplest method. (See diagrams number 1-5)

**Method B:** With Republic-Clic- you can click the planks together without lifting them. This method requires you to use a special Uniclic tapping block and pull bar. The planks should not be joined with a single blow. To avoid damaging the panels, you need to gradually tap them together. (See diagrams 6-7)

## Tools for installing the floor

For best results, it is important that you follow the installation instructions carefully. In addition to the usual vinyl flooring installation tools (i.e. hammer, pull bar, saw, box cutter, pencil, tape measure) you will also need the following supplies:

Republic-Clic--adapted tapping block  
pull bar  
Underlay system if not integrated to the back of your product  
Maintenance products

Using accessories other than the tools recommended by Republic-Clic may damage your new floor. In this case, the Guarantee provided by Republic Floor™. We recommend only using Republic Clic accessories as these have been specifically designed and tested for use with Republic Floor™ decking.

During installation, some floorboards usually have to be cut. To get a clean cut, the pattern side should face down if you're using a box cutter, hacksaw, or hand-held circular saw, and up if you're using a hand saw or miter saw.

## 9 focus points

- Thanks to the Republic-Clic system, the floor "floats" and is laid without glue. The floor can be walked on during and immediately after installation.
- Republic-Clic panels give you the freedom to choose where to start. Think about the easiest way to lay the floor. We demonstrate the right-handed installation from left to right. You can work the other way if you want.
- When laying, make sure that the panels are mixed sufficiently so that there are not too many identical, light or dark panels next to each other.
- Check all panels in daylight before and during installation. Defective panels must never be used.
- The floor should preferably be laid parallel to the incidence of light in the room.
- The ideal conditions are 15-20°C with a relative humidity of 50-60%.
- The humidity in the room can vary depending on the time of year, so it is important that the floor can expand and contract. Therefore, ensure a minimum expansion gap of 8 to 10 mm on all sides of the floor, around pipes, thresholds and under doors.

## Preparing the room

- Check that the doors can still be opened and closed (at least +1 cm) after laying the floor and underlay.
- Make sure the subfloor is level. Unevenness greater than 2 mm over a length of 1 meter must be leveled out.
- The use of an additional impact sound insulation is not necessary because the product already has an integrated high-quality BioGuard™ impact sound insulation.
- In the case of mineral substrates, please first use moisture-proof insulation, 0.2 mm PE as a vapor barrier.
- You do not need any other pads that have a noise-dampening effect. This is integrated under your new high quality Republic Floor™ product.

## WOODEN SUBFLOOR

Remove existing floor coverings. Make sure the floorboard is stable. Apply a leveling coat if necessary (ask your local Republic Floor™ dealer). Lay the panels across the direction of the existing subfloor

## CONCRETE SUBFLOOR:

**New build:**  
A new concrete floor needs at least 1 week to dry for every 1 cm thickness up to 4 cm. Subfloors thicker than 4 cm will take twice as long to dry. For example, a 6 cm thick concrete sub-floor needs at least 8 weeks to dry. The residual moisture content of the screed must be less than 2.0% (CM method) without underfloor heating and less than 1.8% (CM method) with hot water underfloor heating or less. In the case of unheated andrite screeds, the residual moisture must be less than 0.5%. With hot water underfloor heating, the value should be 0.3% or less (CM method).

**Renovation:**  
Remove old floor coverings such as carpet, needle felt, etc. beforehand. Glued PVC, tiles with small tile joints or linoleum do not have to be removed. Always use an underlay if not integrated. Please ask your local Republic Floor™ dealer.

## WOODEN SUBFLOOR

Remove existing floor coverings. Make sure the floorboard is stable. Apply a leveling coat if necessary (ask your local Republic Floor™ dealer). Lay the panels across the direction of the existing subfloor

## CONCRETE SUBFLOOR:

**New build:**  
A new concrete floor needs at least 1 week to dry for every 1 cm thickness up to 4 cm. Subfloors thicker than 4 cm will take twice as long to dry. For example, a 6 cm thick concrete sub-floor needs at least 8 weeks to dry. The residual moisture content of the screed must be less than 2.0% (CM method) without underfloor heating and less than 1.8% (CM method) with hot water underfloor heating or less. In the case of unheated andrite screeds, the residual moisture must be less than 0.5%. With hot water underfloor heating, the value should be 0.3% or less (CM method).

**Renovation:**  
Remove old floor coverings such as carpet, needle felt, etc. beforehand. Glued PVC, tiles with small tile joints or linoleum do not have to be removed. Always use an underlay if not integrated. Please ask your local Republic Floor™ dealer.

## WOODEN SUBFLOOR

Remove existing floor coverings. Make sure the floorboard is stable. Apply a leveling coat if necessary (ask your local Republic Floor™ dealer). Lay the panels across the direction of the existing subfloor

## CONCRETE SUBFLOOR:

**New build:**  
A new concrete floor needs at least 1 week to dry for every 1 cm thickness up to 4 cm. Subfloors thicker than 4 cm will take twice as long to dry. For example, a 6 cm thick concrete sub-floor needs at least 8 weeks to dry. The residual moisture content of the screed must be less than 2.0% (CM method) without underfloor heating and less than 1.8% (CM method) with hot water underfloor heating or less. In the case of unheated andrite screeds, the residual moisture must be less than 0.5%. With hot water underfloor heating, the value should be 0.3% or less (CM method).

**Renovation:**  
Remove old floor coverings such as carpet, needle felt, etc. beforehand. Glued PVC, tiles with small tile joints or linoleum do not have to be removed. Always use an underlay if not integrated. Please ask your local Republic Floor™ dealer.

## WOODEN SUBFLOOR

Remove existing floor coverings. Make sure the floorboard is stable. Apply a leveling coat if necessary (ask your local Republic Floor™ dealer). Lay the panels across the direction of the existing subfloor

## CONCRETE SUBFLOOR:

**New build:**  
A new concrete floor needs at least 1 week to dry for every 1 cm thickness up to 4 cm. Subfloors thicker than 4 cm will take twice as long to dry. For example, a 6 cm thick concrete sub-floor needs at least 8 weeks to dry. The residual moisture content of the screed must be less than 2.0% (CM method) without underfloor heating and less than 1.8% (CM method) with hot water underfloor heating or less. In the case of unheated andrite screeds, the residual moisture must be less than 0.5%. With hot water underfloor heating, the value should be 0.3% or less (CM method).

**Renovation:**  
Remove old floor coverings such as carpet, needle felt, etc. beforehand. Glued PVC, tiles with small tile joints or linoleum do not have to be removed. Always use an underlay if not integrated. Please ask your local Republic Floor™ dealer.

## WOODEN SUBFLOOR

Remove existing floor coverings. Make sure the floorboard is stable. Apply a leveling coat if necessary (ask your local Republic Floor™ dealer). Lay the panels across the direction of the existing subfloor

## CONCRETE SUBFLOOR:

**New build:**  
A new concrete floor needs at least 1 week to dry for every 1 cm thickness up to 4 cm. Subfloors thicker than 4 cm will take twice as long to dry. For example, a 6 cm thick concrete sub-floor needs at least 8 weeks to dry. The residual moisture content of the screed must be less than 2.0% (CM method) without underfloor heating and less than 1.8% (CM method) with hot water underfloor heating or less. In the case of unheated andrite screeds, the residual moisture must be less than 0.5%. With hot water underfloor heating, the value should be 0.3% or less (CM method).

**Renovation:**  
Remove old floor coverings such as carpet, needle felt, etc. beforehand. Glued PVC, tiles with small tile joints or linoleum do not have to be removed. Always use an underlay if not integrated. Please ask your local Republic Floor™ dealer.

## WOODEN SUBFLOOR

Remove existing floor coverings. Make sure the floorboard is stable. Apply a leveling coat if necessary (ask your local Republic Floor™ dealer). Lay the panels across the direction of the existing subfloor

## CONCRETE SUBFLOOR:

**New build:**  
A new concrete floor needs at least 1 week to dry for every 1 cm thickness up to 4 cm. Subfloors thicker than 4 cm will take twice as long to dry. For example, a 6 cm thick concrete sub-floor needs at least 8 weeks to dry. The residual moisture content of the screed must be less than 2.0% (CM method) without underfloor heating and less than 1.8% (CM method) with hot water underfloor heating or less. In the case of unheated andrite screeds, the residual moisture must be less than 0.5%. With hot water underfloor heating, the value should be 0.3% or less (CM method).

**Renovation:**  
Remove old floor coverings such as carpet, needle felt, etc. beforehand. Glued PVC, tiles with small tile joints or linoleum do not have to be removed. Always use an underlay if not integrated. Please ask your local Republic Floor™ dealer.

## WOODEN SUBFLOOR

Remove existing floor coverings. Make sure the floorboard is stable. Apply a leveling coat if necessary (ask your local Republic Floor™ dealer). Lay the panels across the direction of the existing subfloor

## CONCRETE SUBFLOOR:

**New build:**  
A new concrete floor needs at least 1 week to dry for every 1 cm thickness up to 4 cm. Subfloors thicker than 4 cm will take twice as long to dry. For example, a 6 cm thick concrete sub-floor needs at least 8 weeks to dry. The residual moisture content of the screed must be less than 2.0% (CM method) without underfloor heating and less than 1.8% (CM method) with hot water underfloor heating or less. In the case of unheated andrite screeds, the residual moisture must be less than 0.5%. With hot water underfloor heating, the value should be 0.3% or less (CM method).

**Renovation:**  
Remove old floor coverings such as carpet, needle felt, etc. beforehand. Glued PVC, tiles with small tile joints or linoleum do not have to be removed. Always use an underlay if not integrated. Please ask your local Republic Floor™ dealer.

Enjoy your new Republic Floor™ product.